

DIS. COD. 59.9500.00

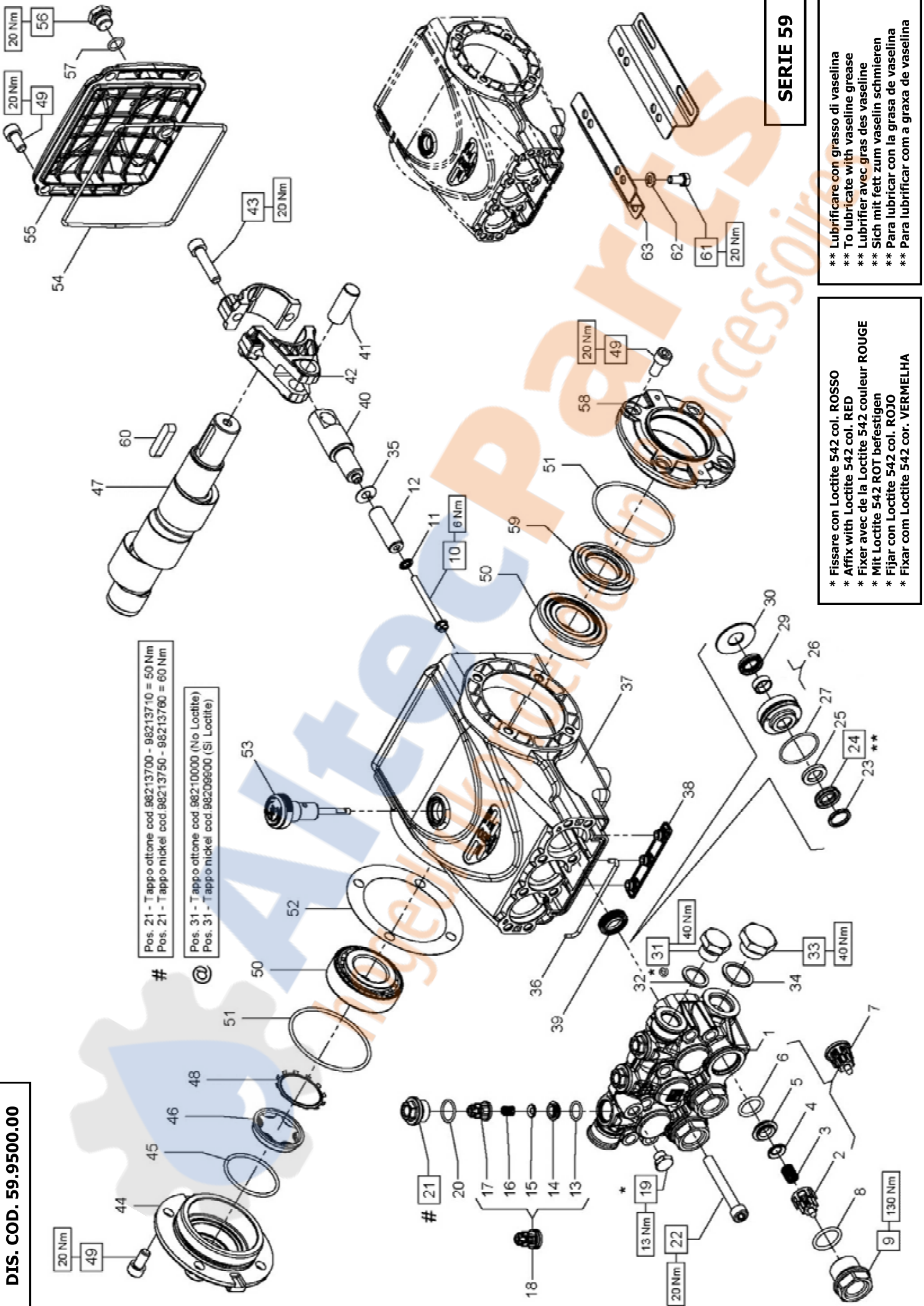

Pos. 21 - Tappo ottone cod. 98213700 - 98213710 = 50 Nm
 Pos. 21 - Tappo nickel cod. 98213750 - 98213760 = 60 Nm

@ Pos. 31 - Tappo ottone cod. 98210000 (No Loctite)
 Pos. 31 - Tappo nickel cod. 98209900 (Si Loctite)

SERIE 59

** Lubrificare con grasso di vaselina
 ** To lubricate with vaseline grease
 ** Lubrifier avec gras des vaseline
 ** Sich mit fett zum vaselin schmieren
 ** Para lubricar con la grasa de vaselina
 ** Para lubrificar com a graxa de vaselina

* Fissare con Loctite 542 col. ROSSO
 * Affix with Loctite 542 col. RED
 * Fixer avec de la Loctite 542 couleur ROUGE
 * Mit Loctite 542 ROT befestigen
 * Fijar con Loctite 542 col. ROJO
 * Fixar com Loctite 542 cor. VERMELHA

KIT RICAMBI – SPARE KITS

KIT Nr.	KIT 269			KIT 292			KIT 271			PIST. D. 13			PIST. D. 15			PIST. D. 18			PIST. D. 20			PIST. D. 22		
	KIT 269	KIT 292	KIT 271	KIT 282	KIT 287	KIT 288	KIT 283	KIT 288	KIT 284	KIT 289	KIT 290	KIT 285	KIT 290	KIT 286	KIT 291									
Posizioni include Positions included	2-3-4 5-6-13 14-15-16 17-(7)-(18)	8-9 20-21	39	23-24 25-27 29	23-24 25-26 27-29 30	23-24 25-26 27-29 30	23-24 25-26 27-29 29	23-24 25-26 27-29 30	23-24 25-26 27-29 29	23-24 25-26 27-29 30	23-24 25-26 27-29 30	23-24 25-26 27-29 29	23-24 25-26 27-29 30	23-24 25-26 27-29 29	23-24 25-26 27-29 30									
Nr. Pcs.	3	3	3	3	1	3	3	1	3	1	3	3	1	3	1									

E3A2113 - E3A2115 - E3B2511 - E3B2513	D. 18	D. 20
E3B2515 - E3B2118 - E3B2121 - E3C2513	E3B2511	E3B2515 - E3B2518 - E3C2521
E3C2515 - E3C2518 - E3C2521 - E3E2813	E3C2513	E3C2518 - E3C2521
E3E2815 - E3E2517 - E3E2520	D. 22	
E3A2113 - E3A2115 - E3B2118 - E3B2121		

POS	COD.	DESCRIZIONE – DESCRIPTION - KIT	NR
16	94.7333.00	Molla Dm. 6.2x10.4	269
17	36.2111.51	Guida valvola di mandata	269
18	36.7193.01	Gr. valvola di mandata	269
19	98.1967.00	Tappo G 1/8"x8	1
20	90.3593.00	OR D.15.60x1.78 NBR 70 SH 2062 292	3
21	98.2137.50	Tappo M18x1.5x10 D.23 - D.12 292	3
22	99.3175.00	Vite M 8x60 UNI 5931	8
23	44.1002.51	Anello di testa D. 13 282-287	
	63.1010.51	Anello di testa D. 15 283-288	
	63.1011.51	Anello di testa D. 18 284-289	
	66.1007.51	Anello di testa D. 20 285-290	
	66.1009.51	Anello di testa D. 22 286-291	
24	90.2602.00	An. ten.alt.D.13x21x4 HP 282-287	
	90.2611.00	An. ten.alt.D.15x24x5.4/3.4 HP 283-288	
	90.2653.50	An. ten.alt.D.18x28x4/3.7 HP 284-289	
	90.2691.00	An. ten.alt.D.20x30x6/3.7 HP 285-290	
	90.2716.00	An. ten.alt.D.22x32x6/3.7 HP 286-291	
25	90.5076.00	Anello antiest. D. 13x21x4 282-287	
	90.5089.90	Anello antiest. D. 15x24x2 283-288	
	90.5111.50	Anello antiest. D. 18x28x2 284-289	
	90.5134.00	Anello antiest. D. 20x30x2 285-290	
	90.5148.50	Anello antiest. D. 22x32x2 286-291	
26	59.6058.01	Gr. supp. guarn./bussola D. 13 287	
	59.6059.01	Gr. supp. guarn./bussola D. 15 288	
	59.6060.01	Gr. supp. guarn./bussola D. 18 289	
	59.6061.01	Gr. supp. guarn./bussola D. 20 290	
	59.6062.01	Gr. supp. guarn./bussola D. 22 291	
27	90.3612.00	OR D. 31.47x1.78 NBR 70 SH. 2125	3
		282-283-284-285-286-287-288-289-290-291	
29	90.2601.00	An. ten. alt. D.13x20x5.0 LP 282-287	
	90.2608.00	An. ten. alt. D.15x22x5.0 LP 283-288	
	90.2650.00	An. ten. alt. D.18x24x5.0 LP 284-289	
	90.2690.00	An. ten. alt. D.20x28x6.5 LP 285-290	
	90.2715.00	An. ten. alt. D.22x30x6.5 LP 286-291	

POS	COD.	DESCRIZIONE – DESCRIPTION - KIT	NR
30	59.2105.70	Anello per tenuta D. 13 287	
	59.2106.70	Anello per tenuta D. 15 288	
	59.2107.70	Anello per tenuta D. 18 289	
	59.2108.70	Anello per tenuta D. 20 290	
	59.2109.70	Anello per tenuta D. 22 291	
31	98.2099.00	Tappo G 3/8"x13	1
32	96.7380.00	Rosetta D. 17.5x23.0x1.5	1
33	98.2179.00	Tappo G 1/2"x10	1
34	96.7514.00	Rosetta D. 21.5x27.0x1.5	1
35	96.6990.00	Rosetta D. 7.5x23.0x0.5	3
36	59.2110.82	Guarnizione spugna D. 3x103	1
37	59.0100.22	Carter pompa	1
38	58.2104.51	Protezione	1
39	90.1565.50	Anello rad. D. 15.0x24.0x5.0/7.0 271	3
40	59.0500.66	Guida pistone	3
41	97.7399.00	Spinotto D. 14x34	3
42	59.0300.01	Biella completa	3
43	99.3099.00	Vite serraggio biella	6
44	47.1512.22	Coperchio laterale lato spia	1
45	90.3877.00	OR D. 39.34x2.62 NBR 70 SH. 3156	1
46	70.2118.01	Spia livello olio	1
	59.0201.35	Alb. ecc. C.13 - E3A2115 E3B2121 E3C2521 E3E2815	
47	59.0202.35	Alb. ecc. C.12 - E3A2113 E3B2118 E3B2515 E3C2518 E3E2520	1
	59.0203.35	Alb. ecc. C.10 - E3B2511 E3B2513 E3C2513 E3C2515 E3E2813 E3E2517	
48	90.0756.00	Anello d'arresto ZJ45	1

POS	COD.	DESCRIZIONE – DESCRIPTION - KIT	NR
1	59.1210.41	Testata pompa D. 13 - NICKEL	1
	59.1211.41	Testata pompa D. 15 - NICKEL	
	59.1212.41	Testata pompa D. 18 - NICKEL	
	59.1213.41	Testata pompa D. 20 - NICKEL	
	59.1214.41	Testata pompa D. 22 - NICKEL	
2	36.2025.51	Guida valvola d'aspirazione	269
3	94.7376.00	Molla Dm. 9.4x14.8	269
4	36.2001.76	Valvola sferica	269
5	36.2003.66	Sede valvola d'aspirazione	269
6	90.3841.00	OR D. 17.13x2.62 NBR 70 SH 3068	269
7	36.7115.01	Gr. valvola d'aspirazione	269
8	90.3847.00	OR D.20.24x2.62 NBR 70 SH 3081 292	3
9	98.2225.00	Tappo M 24x1.5x16.7	292
10	99.1690.00	Vite M 5x55	3
11	96.6905.00	Rosetta D. 5.0x11.5x0.4	3
12	58.0400.09	Pistone D. 13x42	3
	58.0401.09	Pistone D. 15x42	
	58.0402.09	Pistone D. 18x42	
	59.0400.09	Pistone D. 20x42	
	59.0401.09	Pistone D. 22x42	
13	90.3674.00	OR D.12.00x2.00 NBR 70 SH	269
14	36.2113.66	Sede valvola di mandata	269
15	36.2112.76	Valvola sferica	269

**E3A2113 - E3A2115 - E3B2511 - E3B2513
 E3B2515 - E3B2118 - E3B2121 - E3C2513
 E3C2515 - E3C2518 - E3C2521 - E3E2813
 E3E2815 - E3E2517 - E3E2520**

D. 13	D. 15	D. 18	D. 20
E3E2813	E3E2517	E3B2511	E3B2513 - E3B2515 - E3C2515
E3E2815	E3E2520	E3C2513	E3C2518 - E3C2521
D. 22			
E3A2113 - E3A2115 - E3B2118 - E3B2121			

POS	COD.	DESCRIZIONE - DESCRIPTION - KIT	NR
49	99.3039.00	Vite M 8x16 UNI 5931	12
50	91.8375.00	Cuscinetto a rulli	2
51	90.3913.00	OR D. 67.95x2.62 NBR 70 SH. 3628	2
52	97.5680.00 97.5978.00	Spessore D. 74.5x104x0.3 Spessore D. 74.5x104x0.1	1
53	98.2105.00	Asta livello olio G 3/8"x51	1
54	90.3922.00	OR D. 133.02x2.62 NBR 70 SH. 3525	1
55	59.1600.22	Coperchio posteriore carter	1
56	98.2042.50	Tappo G 1/4"x9 TE17 - Zinc.	1
57	90.3585.00	OR D. 10.82x1.78 NBR 70 SH. 2043	1
58	47.1510.22	Coperchio laterale lato PTO	1
59	90.1648.00	Anello rad. D. 30.0x55.0x7.0	1
60	91.4892.00	Linguetta 8.0x7.0x35.0	1
61	99.3037.00	Vite M 8x16 UNI 5739	4
62	96.7016.00	Rosetta D. 8.4x14.4x2.2	4
63	50.2000.74	Piedino pompa	2

KIT RICAMBI - SPARE KITS

KIT Nr.	KIT 269	KIT 292	KIT 271	PIST. D. 13		PIST. D. 15		PIST. D. 18		PIST. D. 20		PIST. D. 22	
				KIT 282	KIT 287	KIT 283	KIT 288	KIT 284	KIT 289	KIT 285	KIT 290	KIT 286	KIT 291
Posizioni include Positions included	2 - 3 - 4 5 - 6 - 13 14 - 15 - 16 17 - (7) - (18)	8 - 9 20 - 21	39	23 - 24 25 - 26 27 - 29 29	23 - 24 25 - 26 27 - 29 30	23 - 24 25 - 26 27 - 29 29	23 - 24 25 - 26 27 - 29 30	23 - 24 25 - 26 27 - 29 30	23 - 24 25 - 26 27 - 29 29	23 - 24 25 - 26 27 - 29 30	23 - 24 25 - 27 29	23 - 24 25 - 26 27 - 29 29	23 - 24 25 - 26 27 - 29 30
Nr. Pcs.	3	3	3	3	1	3	1	3	1	3	3	3	1

